

EA2508-TPE

TERMINALI + CONNETTORI

Terminale

Materiale: Bronzo Fosfo
 Portata: 3A
 Adatto a fili 20/28 AWG
 Utilizza serie EA2508-H

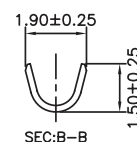
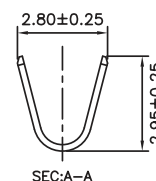
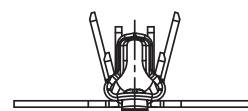
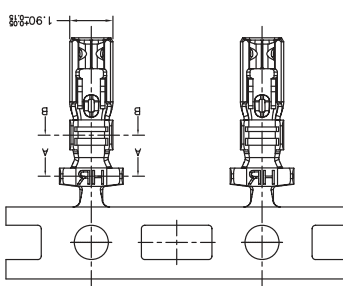
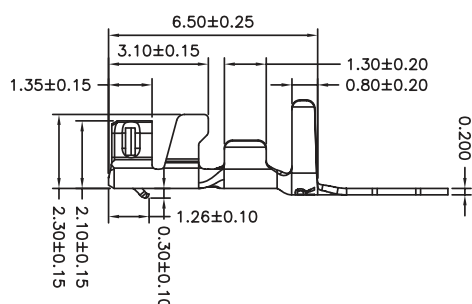
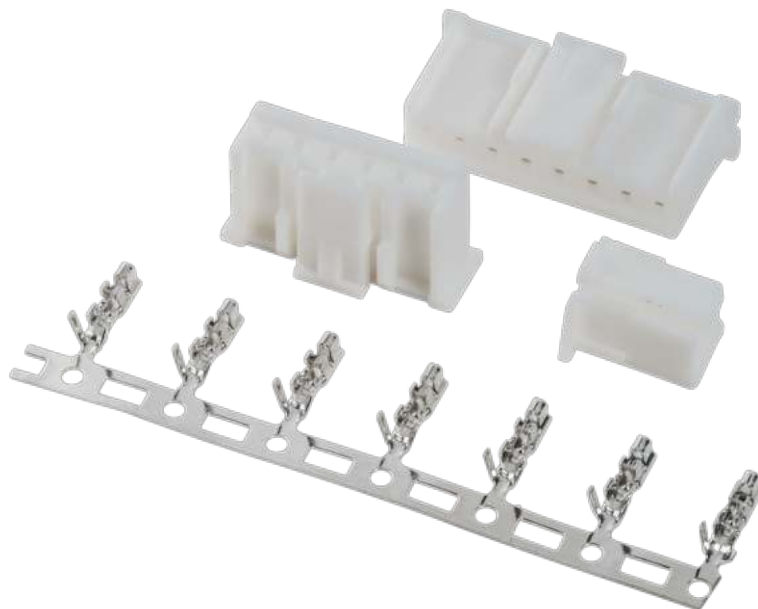

CODICE	SEZ. FILO	MATERIALE	SPESS.	FINITURA	CONF.
EA2508-TPE	AWG 20-28	Bronzo Fosf.	0,20	Stagnato	8.000pz

EA2508-H

TERMINALI + CONNETTORI

Connettore

passo 2.50 mm

Materiale: Nylon 66 UL 94V-0
 Colore: bianco
 Disponibile da 2 a 12 vie
 Utilizza terminale EA2508-TE

CODICE	DIMENSIONI (mm)		CONF.
	A	B	
EA2508H-02P	2.50	7.30	1.000
EA2508H-03P	5.00	9.80	1.000
EA2508H-04P	7.50	12.30	1.000
EA2508H-05P	10.00	14.80	1.000
EA2508H-06P	12.50	17.30	1.000
EA2508H-07P	15.00	19.80	1.000
EA2508H-08P	17.50	22.30	1.000
EA2508H-09P	20.00	24.80	1.000
EA2508H-10P	22.50	27.30	1.000
EA2508H-11P	25.00	29.80	1.000
EA2508H-12P	27.50	32.30	1.000

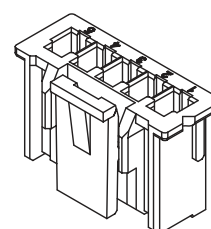
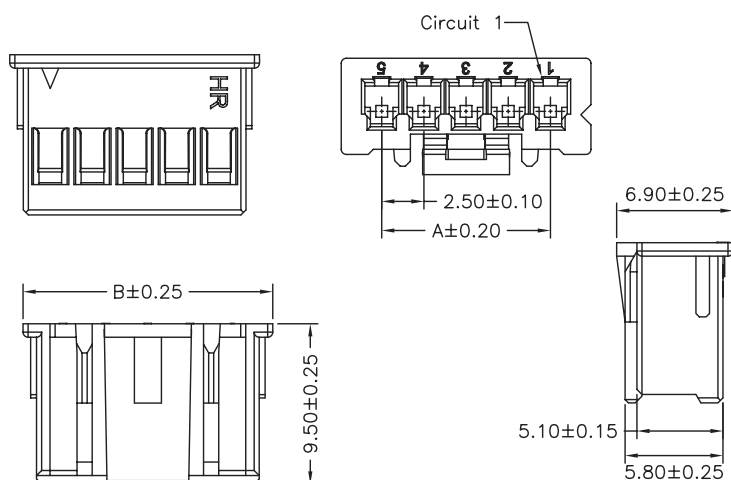

E24 I 9PS-2

TERMINALI + CONNETTORI

Terminale

Materiale: Bronzo fosforoso

Portata massima: 3A @ 250V AC/DC

Adatto a fili da AWG #28 - #22

Utilizzabile nella serie EP2419

Estrattore: EF597

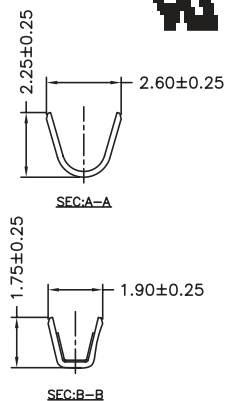
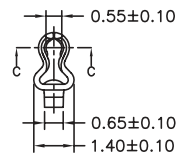
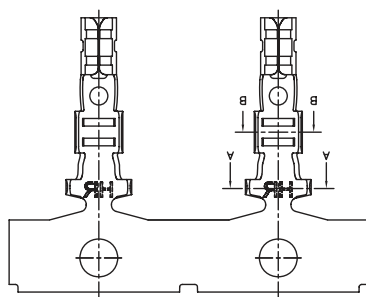
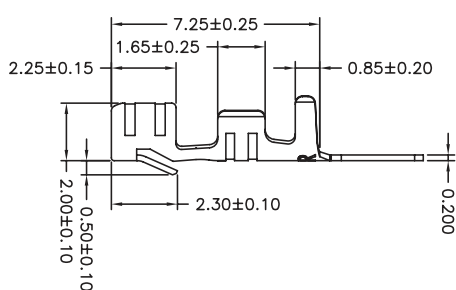
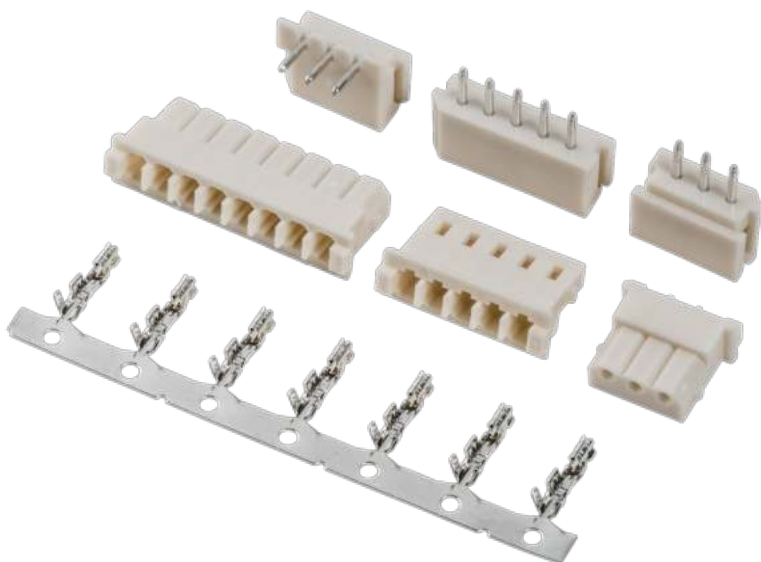

CODICE	SEZ. FILO	MATERIALE	SPESS.	FINITURA	A	B	C	D	DIAM. ISOLANTE	Q.TÀ PER BOBINA
E24I9PS-2	AWG 22 - 28	Bronzo Fosf.	0,20	Stagnato	2,50	2,30	1,77	1,80	1,90	10.000pz

EP2419

TERMINALI + CONNETTORI

Connettore passo 2.50 mm

Materiale: Nylon 66 UL 94V-0

Portata massima: 3A @ 250V AC/DC

Colore: Bianco

Bloccaggio a frizione

Utilizza terminali E24I9PS-2

Interconnessione diretta con le serie EM2419

Disponibile da 2 a 15 vie

N° DI VIE	CODICE	L (MM)	LI (mm)	PI (mm)
2	EP24192	7.40	5.80	2.50
3	EP24193	9.90	8.30	5.00
4	EP24194	12.40	10.80	7.50
5	EP24195	14.90	13.30	10.00
6	EP24196	17.40	15.80	12.50
7	EP24197	19.90	18.30	15.00
8	EP24198	22.40	20.80	17.50
9	EP24199	24.90	23.30	20.00
10	EP241910	27.40	25.80	22.50
11	EP241911	29.90	28.30	25.00
12	EP241912	32.40	30.80	27.50
13	EP241913	34.90	33.30	30.00
14	EP241914	37.40	35.80	32.50
15	EP241915	39.90	38.30	35.00

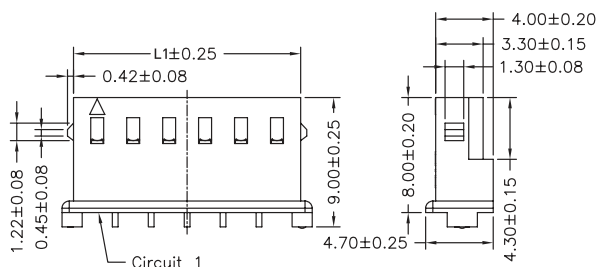
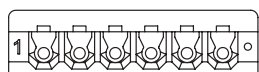
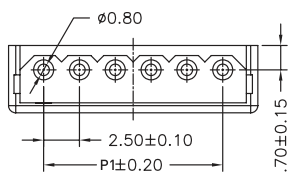

EM24I9/EM24I9R

TERMINALI + CONNETTORI

Maschi dritti e a 90°
passo 2.50 mm

Materiale: Nylon 66 UL 94V-0

Portata massima: 3A @ 250V AC/DC

Pin tondo da 0.70mm (.027") in ottone stagnato

Bloccaggio a frizione & Polarizzato

Interconnessione diretta con la serie EP24I9

Disponibile da 2 a 15 vie

N° DI VIE	CODICE		DIMENSIONI (MM)	
	VERS. DRITTA	VERS. A 90°	L	PI
2	EM24I92	EM24I92R	7.50	2.50
3	EM24I93	EM24I93R	10.00	5.00
4	EM24I94	EM24I94R	12.50	7.50
5	EM24I95	EM24I95R	15.00	10.00
6	EM24I96	EM24I96R	17.50	12.50
7	EM24I97	EM24I97R	20.00	15.00
8	EM24I98	EM24I98R	22.50	17.50
9	EM24I99	EM24I99R	25.00	20.00
10	EM24I910	EM24I910R	27.50	22.50
11	EM24I911	EM24I911R	30.00	25.00
12	EM24I912	EM24I912R	32.50	27.50
13	EM24I913	EM24I913R	35.00	30.00
14	EM24I914	EM24I914R	37.50	32.50
15	EM24I915	EM24I915R	40.00	35.00

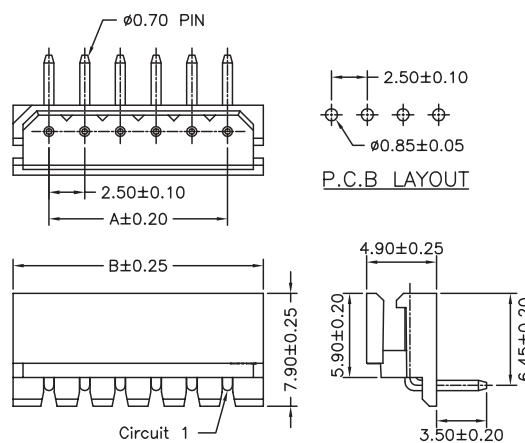
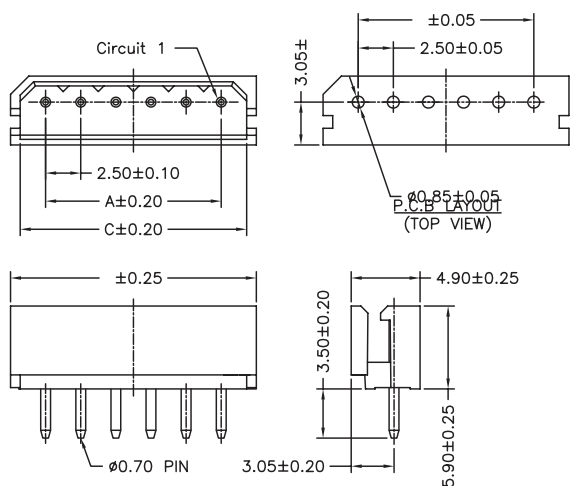

MASCHIO
DRITTO

MASCHIO
A 90°

E2428PS-2

TERMINALI + CONNETTORI

Terminale

Materiale: Bronzo fosforoso

Portata massima: 3A @ 250V AC/DC

Adatto a fili da AWG #30 - #22

Utilizzabile nella serie EP2428

Estrattore: EF594

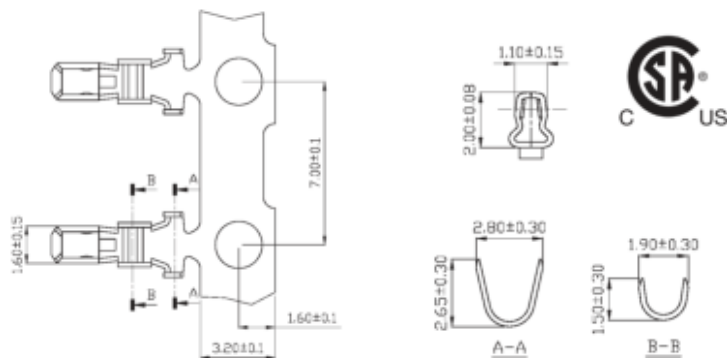
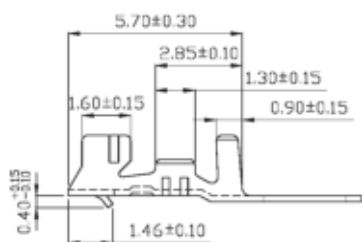
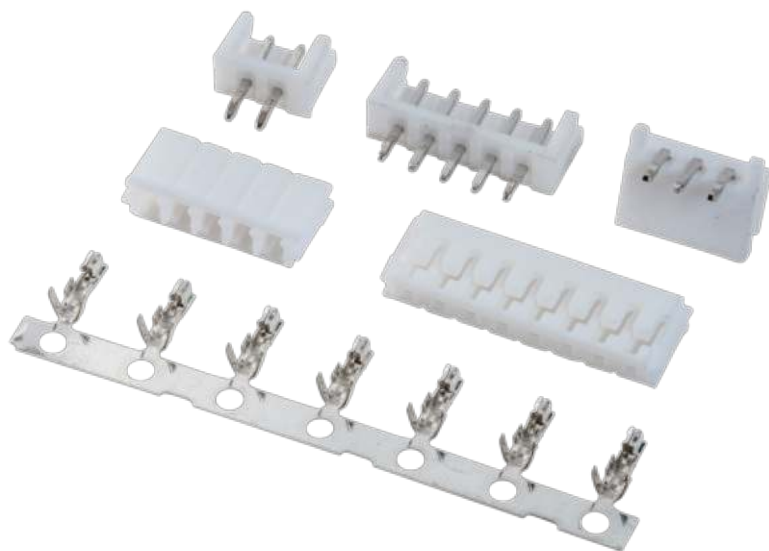

CODICE	SEZ. FILO	MATERIALE	SPESS.	FINITURA	A	B	C	D	DIAM. ISOLANTE	Q.TÀ PER BOBINA
E2428PS-2	AWG 22 - 30	Bronzo Fosf.	0,20	Stagnato	2,80	2,65	1,90	1,50	1,70	10.000pz

EP2428

TERMINALI + CONNETTORI

Connettore

passo 2.50 mm

Materiale: Nylon UL 94V-0

Portata massima: 3A @ 250V AC/DC

Colore: Bianco

Utilizza terminali E2428PS-2

Interconnessione diretta con le serie EM2428/EM2428R

Disponibile da 2 a 15 vie

N° DI VIE	CODICE	L (mm)	LI (mm)	PI (mm)
2	EP24282	6.90	5.30	2.50
3	EP24283	9.40	7.80	5.00
4	EP24284	11.90	10.30	7.50
5	EP24285	14.40	12.80	10.00
6	EP24286	16.90	15.30	12.50
7	EP24287	19.40	17.80	15.00
8	EP24288	21.90	20.30	17.50
9	EP24289	24.40	22.80	20.00
10	EP242810	27.50	25.30	22.50
11	EP242811	30.00	27.80	25.00
12	EP242812	32.50	30.30	27.50
13	EP242813	35.00	32.80	30.00
14	EP242814	37.50	35.30	32.50
15	EP242815	40.00	37.80	35.00

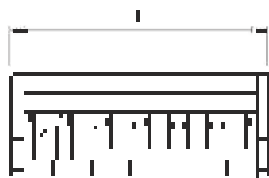

EM2428/EM2428R

TERMINALI + CONNETTORI

Maschi dritti e a 90°
passo 2.50 mm

Materiale: Nylon UL 94V-0

Portata massima: 3A @ 250V AC/DC

Colore standard: Bianco

Pin quadro da 0.64mm (0.025")

Interconnessione diretta con la serie EP2428

Disponibile da 2 a 15 vie

N° DI VIE	VERS. DRIITTA	VERS. A 90°	L (mm)	LI (mm)	PI (mm)
2	EM24282	EM24282R	7.50	5.50	2.50
3	EM24283	EM24283R	10.00	8.00	5.00
4	EM24284	EM24284R	12.50	10.50	7.50
5	EM24285	EM24285R	15.00	13.00	10.00
6	EM24286	EM24286R	17.50	15.50	12.50
7	EM24287	EM24287R	20.00	18.00	15.00
8	EM24288	EM24288R	22.50	20.50	17.50
9	EM24289	EM24289R	25.00	23.00	20.00
10	EM242810	EM242810R	27.50	25.50	22.50
11	EM242811	EM242811R	30.00	28.00	25.00
12	EM242812	EM242812R	32.50	30.50	27.50
13	EM242813	EM242813R	35.00	33.00	30.00
14	EM242814	EM242814R	37.50	35.50	32.50
15	EM242815	EM242815R	40.00	38.00	35.00

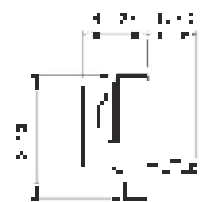
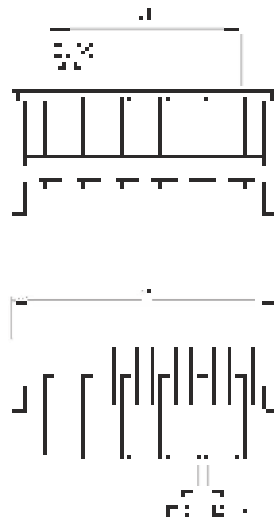
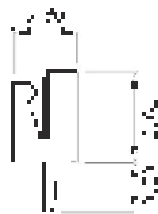
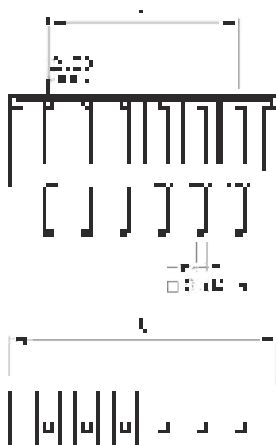

MASCHIO
Dritto

MASCHIO
A 90°

E24 I 85BS-2

TERMINALI + CONNETTORI

Terminale

- Materiale: Ottone stagnato (**E24 I 85BS-2**)
- Portata massima: 3A @ 250V AC/DC
- Adatto a fili da AWG #26 - #22
- Utilizzabile nella serie EP24 I 85
- Estrattore: **EF589**

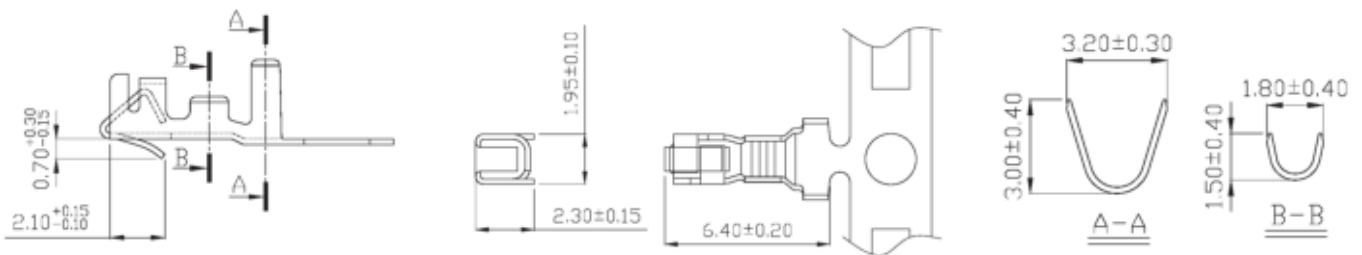
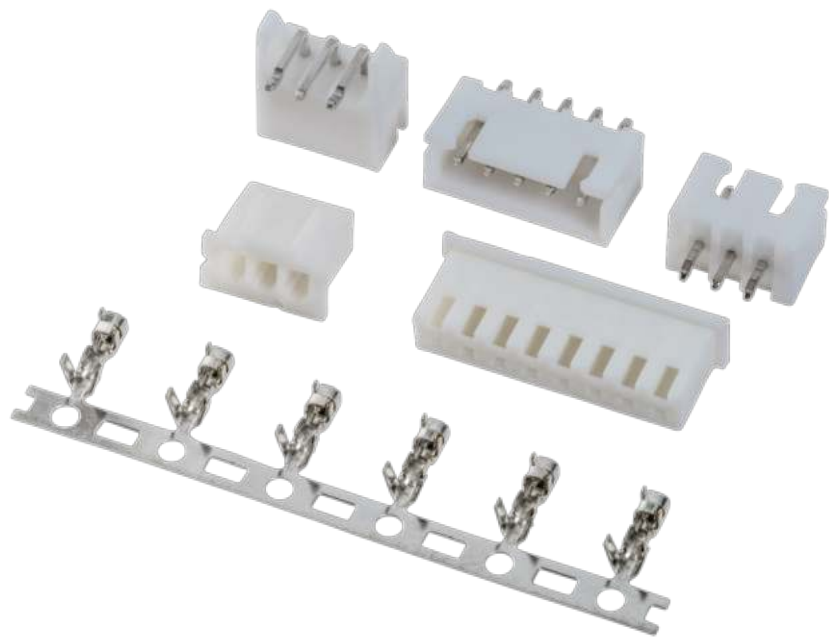

CODICE	SEZ. FILO	MATERIALE	SPESS.	FINITURA	A	B	C	D	DIAM. ISOLANTE	Q.TÀ PER BOBINA
E24I85BS-2	AWG 22 - 26	Ottone	0,20	Stagnato	3,20	3,00	1,80	1,50	2,20	7.500pz
E24I85PS-2	AWG 22 - 26	Bronzo Fosf.	0,20	Stagnato	3,20	3,00	1,80	1,50	2,20	7.500pz

EP24 I 85

TERMINALI + CONNETTORI

Connettore

passo 2.50 mm

- Materiale: Nylon UL 94V-0
- Portata massima: 3A @ 250V AC/DC
- Colore: Bianco
- Utilizza terminali E24I85BS-2
- Interconnessione diretta con le serie EM2428/EM2428R
- Disponibile da 2 a 15 vie

N° DI VIE	CODICE	PI (mm)	L (mm)
2	EP24I852	2.50	5.70
3	EP24I853	5.00	8.20
4	EP24I854	7.50	10.70
5	EP24I855	10.00	13.20
6	EP24I856	12.50	15.70
7	EP24I857	15.00	18.20
8	EP24I858	17.50	20.70
9	EP24I859	20.00	23.20
10	EP24I8510	22.50	25.70
11	EP24I8511	25.00	28.20
12	EP24I8512	27.50	30.70
13	EP24I8513	30.00	33.20
14	EP24I8514	32.50	35.70
15	EP24I8515	35.00	38.20
16	EP24I8516	37.50	40.70
17	EP24I8517	40.00	43.20
18	EP24I8518	42.50	45.70
19	EP24I8519	45.00	48.20
20	EP24I8520	47.50	50.70

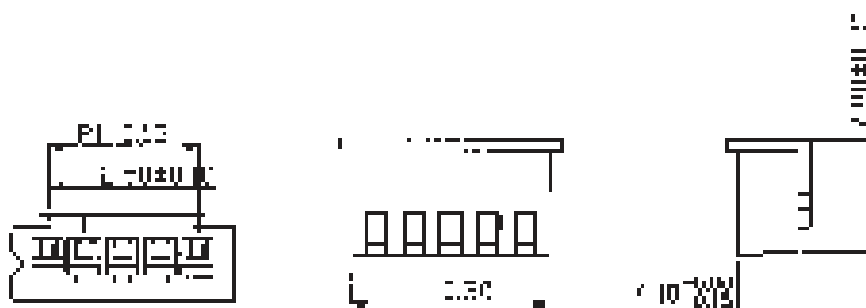

EM24I85/EM24I85R

TERMINALI + CONNETTORI

Maschi dritti e a 90°
passo 2.50 mm

- Materiale: Nylon UL 94V-0
- Portata massima: 3A @ 250V AC/DC
- Pin quadro da 0.64mm (0.025")
- Interconnessione diretta con la serie EP24I85
- Disponibile da 2 a 20 vie

N° DI VIE	CODICE ELMAC		DIMENSIONI (mm)	
	VERSIONE DRITTA	VERSIONE A 90°	PI	L
2	EM24I852	EM24I852R	2.50	7.40
3	EM24I853	EM24I853R	5.00	9.90
4	EM24I854	EM24I854R	7.50	12.40
5	EM24I855	EM24I855R	10.00	14.90
6	EM24I856	EM24I856R	12.50	17.40
7	EM24I857	EM24I857R	15.00	19.90
8	EM24I858	EM24I858R	17.50	22.40
9	EM24I859	EM24I859R	20.00	24.90
10	EM24I8510	EM24I8510R	22.50	27.40
11	EM24I8511	EM24I8511R	25.00	29.90
12	EM24I8512	EM24I8512R	27.50	32.40
13	EM24I8513	EM24I8513R	30.00	34.90
14	EM24I8514	EM24I8514R	32.50	37.40
15	EM24I8515	EM24I8515R	35.00	39.90
16	EM24I8516	EM24I8516R	37.50	42.40
17	EM24I8517	EM24I8517R	40.00	44.90
18	EM24I8518	EM24I8518R	42.50	47.40
19	EM24I8519	EM24I8519R	45.00	49.90
20	EM24I8520	EM24I8520R	47.50	52.40

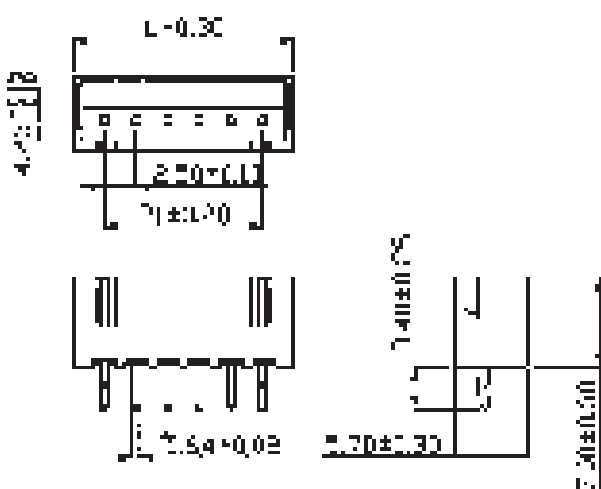

MASCHIO
DRITTO

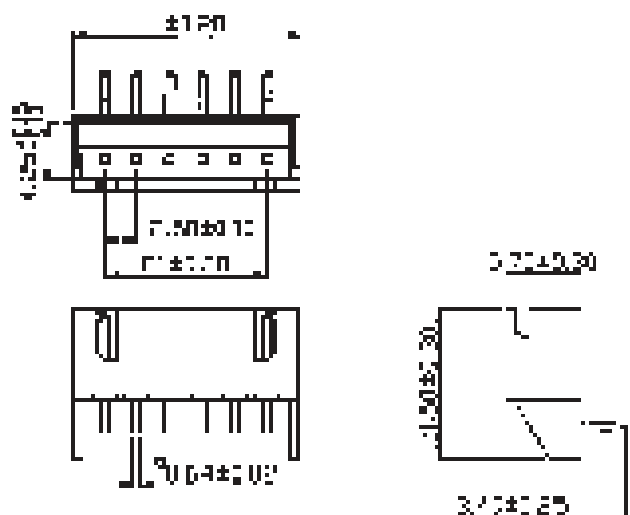

MASCHIO
A 90°

EI0115BS-2/EI0116BS-2

TERMINALI + CONNETTORI

Terminale

Materiale: Ottone stagnato

Portata massima: 2.5A @ 250V AC/DC

Adatto a fili da AWG #28 - #22

Utilizzabile nella serie EP10115

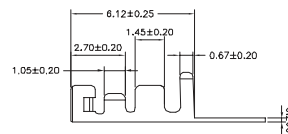
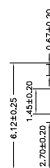
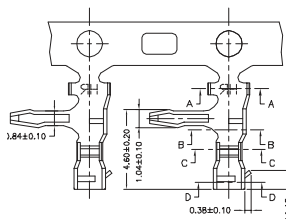
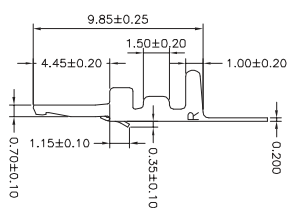
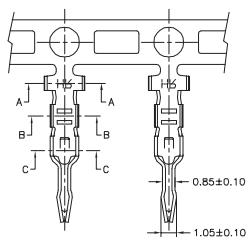
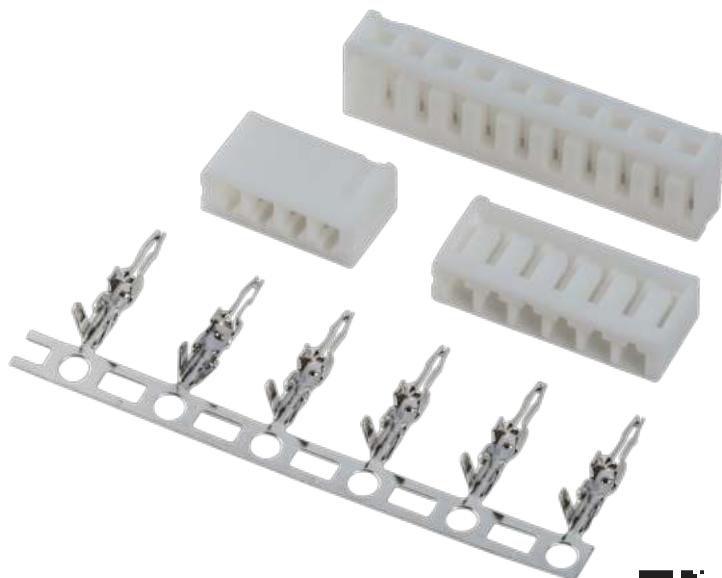

MASCHIO
DRITTO

EI0115BS-2

MASCHIO
A 90°

EI0116BS-2

CODICE	SEZ. FILO	MATERIALE	SPESS.	FINITURA	A	B	C	D	DIAM. ISOLANTE	Q.TÀ PER BOBINA
EI0115BS-2	AWG 22 - 28	Ottone	0,20	Stagnato	2,40	3,00	1,80	1,50	1,60	10.000pz
EI0116BS-2	AWG 22 - 28	Ottone	0,20	Stagnato	2,40	3,00	1,80	1,50	1,60	10.000pz

EPI0115/EPI0116

TERMINALI + CONNETTORI

Connettore

passo 2.50 mm

Materiale: Nylon

Portata massima: 2.5A @ 250V AC/DC

Utilizza terminali EI0115BS-2

Disponibile da 2 a 16 vie

N° DI VIE	CODICE	COD. 90°	L (mm)	PI (mm)
2	EPI01152	EPI01162	6.50	2.50
3	EPI01153	EPI01163	9.00	5.00
4	EPI01154	EPI01164	11.50	7.50
5	EPI01155	EPI01165	14.00	10.00
6	EPI01156	EPI01166	16.50	12.50
7	EPI01157	EPI01167	19.00	15.00
8	EPI01158	EPI01168	21.50	17.50
9	EPI01159	EPI01169	24.00	20.00
10	EPI011510	EPI011610	26.50	22.50
11	EPI011511	EPI011611	29.00	25.00
12	EPI011512	EPI011612	31.50	27.50
13	EPI011513	EPI011613	34.00	30.00
14	EPI011514	EPI011614	36.50	32.50
15	EPI011515	EPI011615	39.00	35.00
16	EPI011516	EPI011616	41.50	37.50

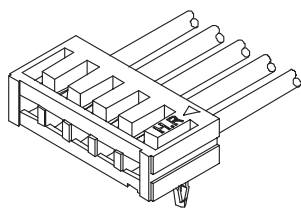
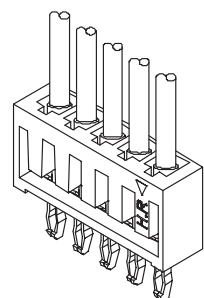

MASCHIO
DRITTO
EPI0115

MASCHIO
A 90°
EPI0116

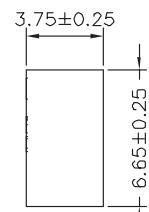
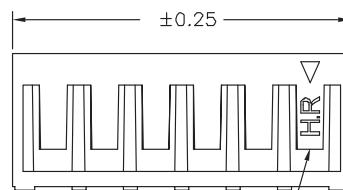
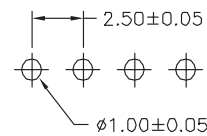
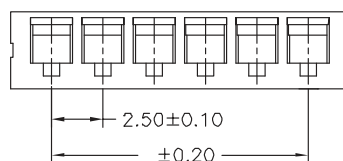

E54T

TERMINALI + CONNETTORI

Terminale

Materiale: Bronzo fosforoso stagnato
 Portata massima: 1.5A @ 250V AC/DC
 Basso profilo
 4 punti di contatto
 Adatto a fili da AWG #28 - #22
 Utilizzabile nella serie E2502

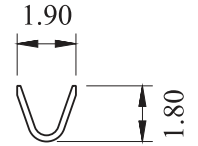
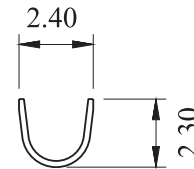
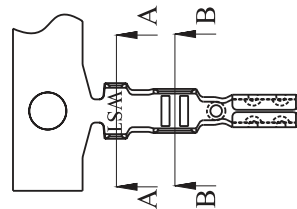
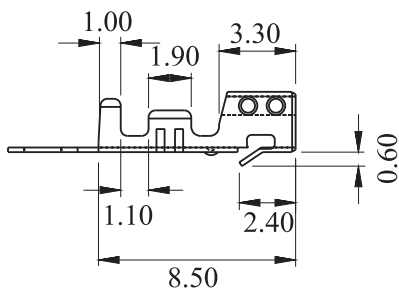
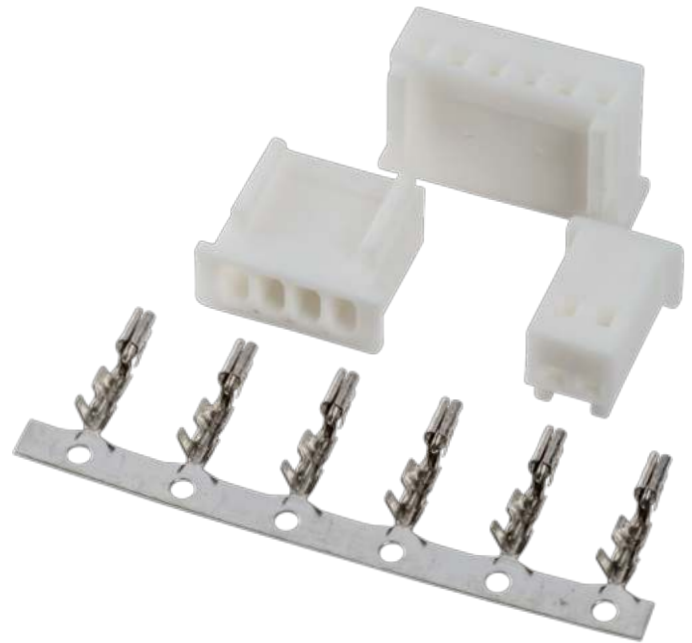

A-A SECTION

B-B SECTION

CODICE	SEZ. FILO	MATERIALE	SPESS.	FINITURA	A	B	C	D	DIAM. ISOLANTE	Q.TÀ PER BOBINA
E54T	AWG 22 - 28	Bronzo Fosf.	0,20	Stagnato	2,40	2,20	1,80	1,85	1,90	10.000pz

E2502

TERMINALI + CONNETTORI

Connettore

passo 2.50 mm

Materiale: Nylon UL 94V-0
 Portata massima: 1.5A @ 250V AC/DC
 Colore: Bianco
 Utilizza terminali E54T
 Interconnessione diretta con
 la serie E2540 / E2541
 Disponibile da 2 a 20 vie

N° DI VIE	CODICE	A (mm)	B (mm)
2	E2502-02	2.50	6.00
3	E2502-03	5.00	8.50
4	E2502-04	7.50	11.00
5	E2502-05	10.00	13.50
6	E2502-06	12.50	16.00
7	E2502-07	15.00	18.50
8	E2502-08	17.50	21.00
9	E2502-09	20.00	23.50
10	E2502-10	22.50	26.00
11	E2502-11	25.00	28.50
12	E2502-12	27.50	31.00
13	E2502-13	30.00	33.50
14	E2502-14	32.50	36.00
15	E2502-15	35.00	38.50
16	E2502-16	37.50	41.00
17	E2502-17	40.00	43.50
18	E2502-18	42.50	46.00
19	E2502-19	45.00	48.50
20	E2502-20	47.50	51.00

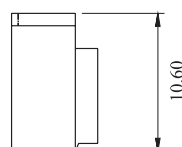
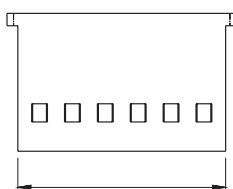
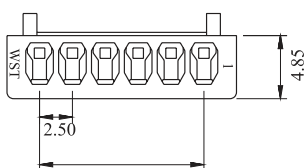

E4IT

TERMINALI + CONNETTORI

Terminale

Materiale: Bronzo fosforoso

Portata massima: 1.5A @ 250V AC/DC

Adatto a fili da AWG #22 - #28

Utilizzabile nella serie E2540 / E2541

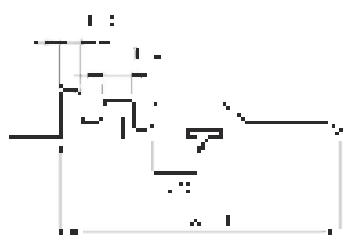
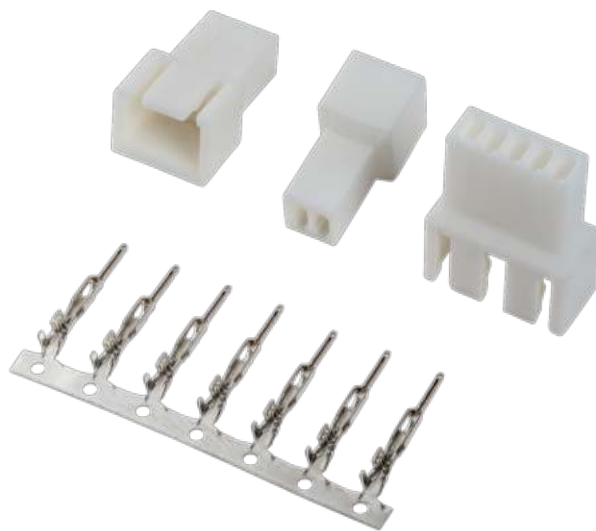

CODICE	SEZ. FILO	MATERIALE	SPESS.	FINITURA	A	B	C	D	DIAM. ISOLANTE	Q.TÀ PER BOBINA
E4IT	AWG 22 - 28	Bronzo Fosf.	0,20	Stagnato	2,40	2,20	1,80	1,85	1,90	15.000pz

E2540

TERMINALI + CONNETTORI

Connettore

passo 2.50 mm

Materiale: Nylon UL 94V-0 o UL 94V-2

Portata massima: 1.5A @ 250V AC/DC

Colore: Bianco

Con alette di fissaggio (E2541)

Senza alette di fissaggio (E2540)

Utilizza terminali E4IT

Interconnessione diretta con la serie E2502

Disponibile da 2 a 12 vie

N° DI VIE	CODICE ELMAC	DIMENS. (mm)	
	SENZA ALETTE	A	B
2	E2540-02	2.50	8.60
3	E2540-03	5.00	11.10
4	E2540-04	7.50	13.60
5	E2540-05	10.00	16.10
6	E2540-06	12.50	18.60
7	E2540-07	15.00	21.10
8	E2540-08	17.50	23.60
9	E2540-09	20.00	26.10
10	E2540-10	22.50	28.60
11	E2540-11	25.00	31.10
12	E2540-12	27.50	33.60

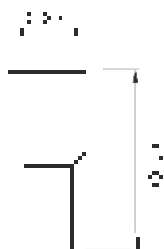

EYA5005-T

TERMINALI + CONNETTORI

Terminale

Materiale: Bronzo fosforoso

Finitura: Stagnato

Portata massima: 5.0A @ 250V AC/DC

Utilizzabile nella serie EYA5005-Hxx

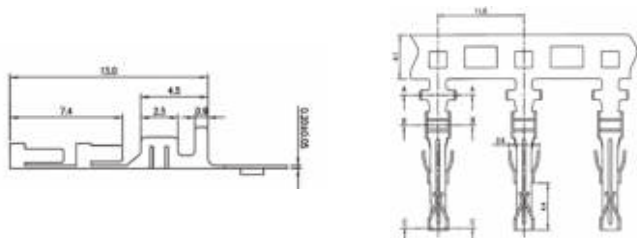
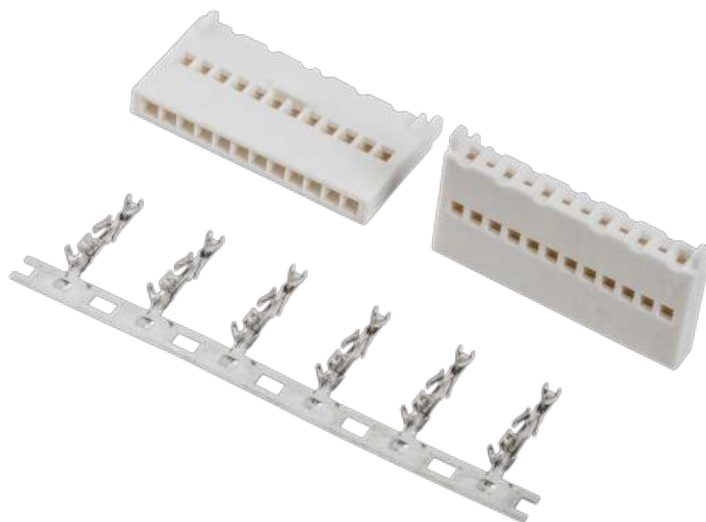

CODICE	SEZ. FILO	MATERIALE	SPESS.	FINITURA	A	B	C	D	DIAM. ISOLANTE	Q.TÀ PER BOBINA
EYA5005-TTA	0,3 - 0,6mm ²	Bronzo Fosf.	0,20	Stagnato	3,40	2,70	2,40	2,20	2,10	8.000 pz

EYA5005-H

TERMINALI + CONNETTORI

Connettore

passo 2.50 mm

Materiale: Nylon UL 94V-0

GWT 750°C secondo IEC 60335-1 NF

Portata massima: 5.0A @ 250V AC/DC

Temperatura di utilizzo: -40°C / +120°C

Colore: Bianco

Disponibile con varie polarizzazioni (Vedi tabella)

Utilizza terminali EYA5005-TTA

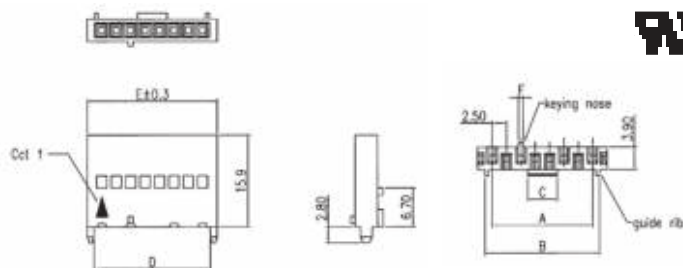

N.RO VIE	KEYING	COD. ELMAC	A	B	C	D	E	F	CONFIGURAZIONE
2	00	EYA5005-H02-00	2.5	5.2	1.2	5.2	7.5	---	
3	00	EYA5005-H03-00	5.0	7.7	3.2	7.7	10.0	---	
4	00	EYA5005-H04-00	7.5	10.2	5.1	10.2	12.5	---	
5	01	EYA5005-H05-01	10.0	12.4	5.1	12.7	15.0	0.8	
6	00	EYA5005-H06-00	12.5	14.9	5.1	15.2	17.5	---	
6	02	EYA5005-H06-02	12.5	14.9	5.1	15.2	17.5	0.8	
7	00	EYA5005-H07-00	15.0	17.4	5.1	17.7	20.0	---	
8	03	EYA5005-H08-03	17.5	19.9	5.1	20.2	22.5	0.8	
9	03	EYA5005-H09-03	20.0	22.4	5.1	22.7	25.0	0.8	
10	00	EYA5005-H10-00	22.5	24.9	5.1	25.2	24.5	---	
11	04	EYA5005-H11-04	25.0	27.4	5.1	27.7	30.0	0.8	
12	00	EYA5005-H12-00	27.5	29.9	5.1	30.2	32.5	---	
13	05	EYA5005-H13-05	30.0	32.4	5.1	32.7	35.0	0.8	